

# 6 OPzS 600

## Technical Characteristics

Nominal Voltage	2.00	Volt/cell
Capacity	600	Ah/Cell
Density of electrolyte	1.24	gr/cm <sup>3</sup>
Floating charge voltage	2.23	Volt/Cell
Max. Charge voltage	2.60	Volt/Cell
Internal Resistance	0.47	mohm/Cell
Short circuit current	4350	A
Length	145	mm
Width	206	mm
Height	671	mm
Weight (Full charged)	46	Kg
Weight (Dry charged)	33	Kg
Expected lifetime	15-20 years	

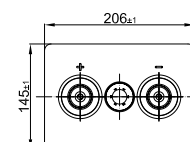
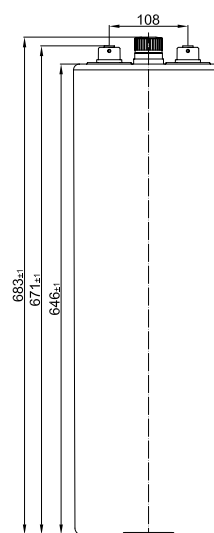

# 6 OPzS 600

## DISCHARGE TABLE ( IN TERMS OF POWER) (CONSTANT DISCHARGE POWER - Watts / Cell)

**V<sub>f</sub> : 1,80 Volt/Cell**

15 min.	1h	3h	4h	5h	8h	10h
Watt	Watt	Watt	Watt	Watt	Watt	Watt
663	482	290	242	207	148	125

## DISCHARGE TABLE ( IN TERMS OF CURRENT) (CONSTANT DISCHARGE CURRENT - Amperes)

**V<sub>f</sub> : 1,80 Volt/Cell**

15 min.	1h	3h	4h	5h	8h	10h
A	A	A	A	A	A	A
380	258	143	118	102	72	60

## Diagrams

Self-discharge characteristics

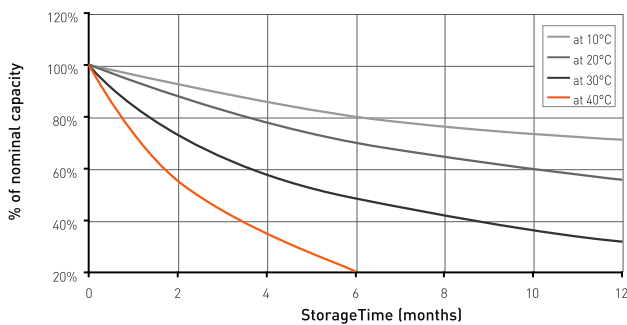

Service Life vs Temperature

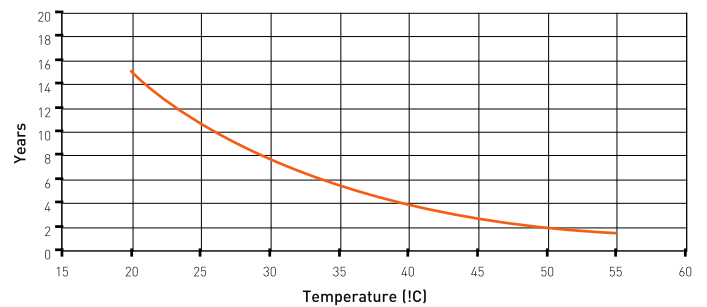

Expected Cycle-Life vs D.O.D

